

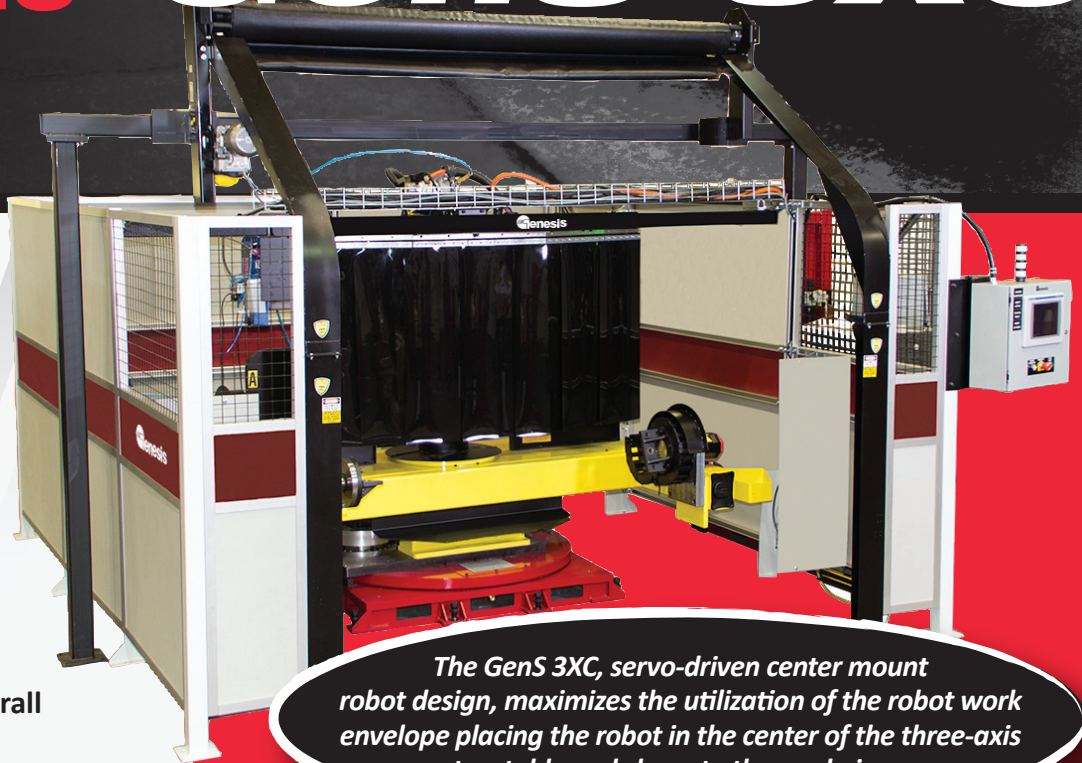

GenS 3XC



KEY FEATURES

- **Productivity**
 - Fast index time reduces overall weld cycle time
 - Multiple robot configurations
 - Center mount robot design allows automated unload of parts from weld station
- **Functionality**
 - Quick installation – robot and positioner on unitized base
 - High utilization of robot work envelope with center robot design
 - Safer robot programming with center mount robot
 - Center mount robot design reduces required floor space
 - Cost efficient servo main sweep design
- **Reliability**
 - Pre-engineered, proven design
 - Single source responsibility
 - 24-hour support service
- **Flexibility**
 - Able to accommodate large tool lengths, swing diameters and high weight capacity
 - Easily configured to meet application requirements

The GenS 3XC, servo-driven center mount robot design, maximizes the utilization of the robot work envelope placing the robot in the center of the three-axis turntable and closer to the workpiece.

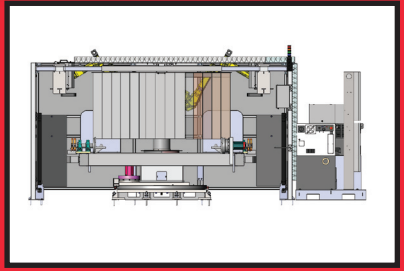
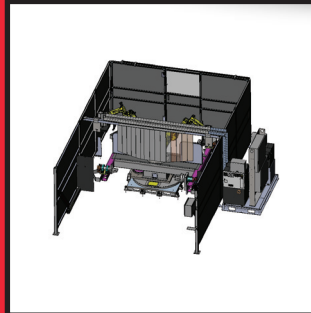

Base Positioner Configuration

Main axis - servo driven	
Main sweep index time	4.5 to 5.0 seconds
Minor axis – dual servo driven trunnions	
Tool length	2.0-meters (78-inches)
Tool swing diameter	1.25-meters (49-inches)
Weight capacity	1,000-kilograms (2,204-lbs)

Base Component Configuration

- FANUC ArcMate 100iC or Panasonic TA-1400 G3
- Lincoln i400 or Miller Auto Axxess 300
- Tregaskiss, Binzel or TBi air-cooled through arm torch
- Genesis torch alignment package
- Safety package (includes light curtains, gate interlock and barriers)
- Genesis Allen-Bradley controls package with L1 processor
- Rotary ground

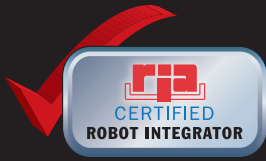

GenS 3XC

Standard Dimensional Specifications

- Tool length **TL**
2.0-meters (78-inches) to 3.0-meters (118-inches)
- Tool swing diameter **SD**
1.25-meters (49-inches)
- Load height **LH**
1.0-meter (39-inches)
- Cell width **CW**
3490-mm (137-inches) to 4510-mm (177-inches)
- Cell depth **CD**
4490-mm (176-inches) to 5510-mm (216-inches)
- Cell height **CH**
2600-mm (102-inches)

Standard Capacity Specifications

- Weight capacity
1,000-kilograms (2,204-lbs)
- Engineering specifications for 1,000-kilograms capacity per station
 - Main axis
 - Out of balance - Station A to Station B 900-kilograms
 - 180-degree index time under 5.0 seconds
 - Minor axis
 - Gearbox rated torque 1617Nm
 - Gearbox ratio 161:1
 - Gearbox maximum moment 2940Nm
 - Motor maximum RPM 4,000
 - Motor torque output 12Nm
 - Nominal acceleration .5 seconds
 - Allowable tool out of balance torque 250Nm
 - 180-degree index time 2.0 seconds

Standard Platform Options

- Tool length 2.5-meters, 3.0-meters
- Exposed power track cable carrier system
- Smoke hood and extraction system
- Off-line programming
- LaunchIT or standard installation
- Training programs (basic, advanced, maintenance, off-line, CRAW)
- Intelligence Center™

Standard Component Options

- Robot models: FANUC, Panasonic, Motoman
- Process gear: Miller, Lincoln, Fronius, Thermadyne, Hypertherm
- Welding torches: Tregaskiss, Binzel, TBI, Fronius
- Torch cleaners: Tregaskiss, Binzel, TBI
- Controls: PanelView 1000+ Compact

TOP VIEW

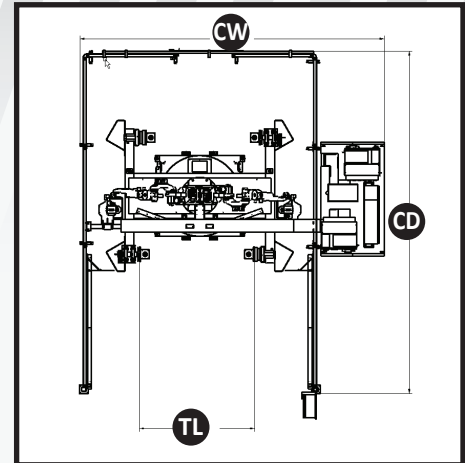

SIDE VIEW

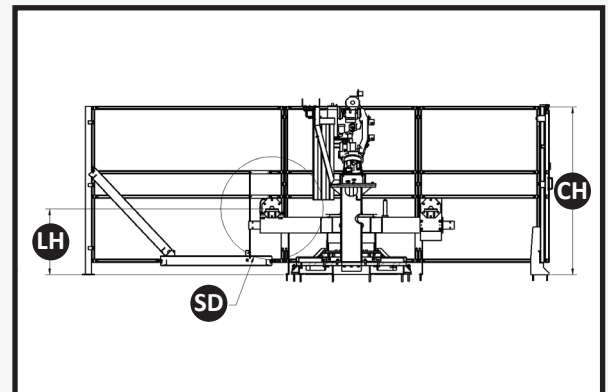

*Real time status, alarms, historical trends,
critical parameters and automatic backup of
your workcell anywhere, anytime.*