

Genesis[®] VERSA RC3L

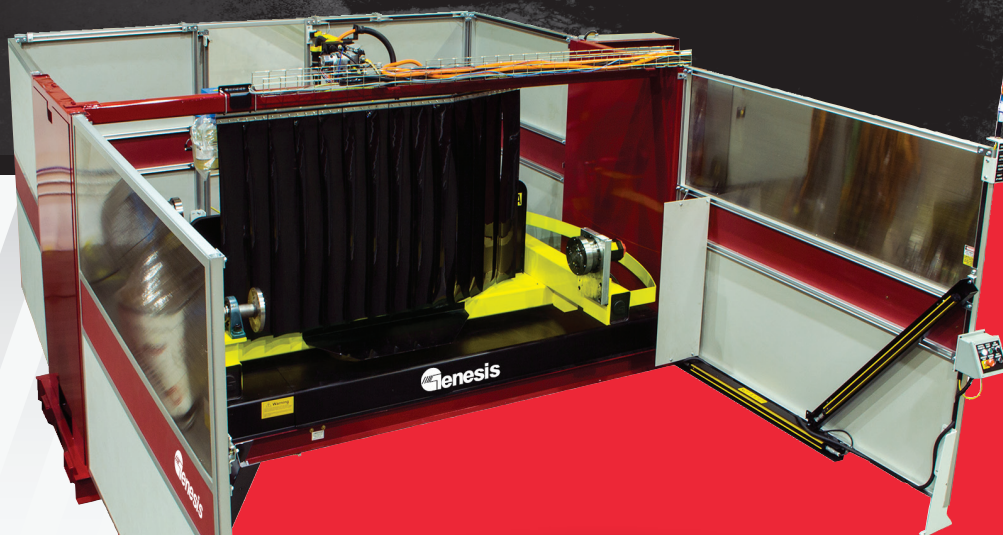

KEY FEATURES

• Productivity

- Fast index time reduces overall weld cycle time
- Multiple robot configurations
- Design allows automated unload of parts from weld station

• Functionality

- Quick installation – robot, positioner and controls on unitized base
- High utilization of robot work envelope with center robot design
- Safer robot programming with center mounted robot
- Center mount robot design reduces required floor space
- Cost efficient pneumatic main sweep design

• Reliability

- Pre-engineered, proven design
- Single source responsibility
- 24-hour support service

• Flexibility

- Able to accommodate large tool lengths, swing diameters and high weight capacity
- Easily configured to meet application requirements

The Versa RC3L center mount robot design maximizes the utilization of the robot work envelope placing the robot in the center of the three-axis turntable and closer to the workpiece.

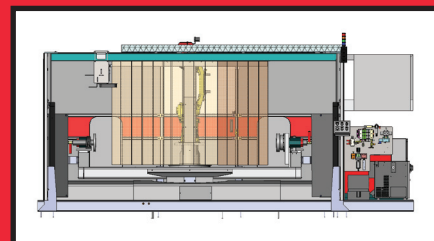
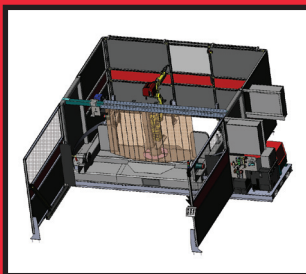

Base Positioner Configuration

Main axis - pneumatically driven

Main sweep index time 4.5 to 6.0 seconds

Minor axis – dual servo driven trunnions

Tool length 60-inches (1524-mm)

Tool swing diameter 40-inches (1016-mm)

Weight capacity 1,200-lbs (544-kg)

Base Component Configuration

FANUC ArcMate 100iC or Panasonic TA-1400 G3

Lincoln i400 or Miller Auto Axxess 300

Tregaskiss, Binzel or TBI air-cooled through arm torch

Genesis torch alignment package

Safety package (includes light curtains, gate interlock and barriers)

Genesis Allen-Bradley controls package with L1 processor

Rotary ground

INNOVATION AND EXPERIENCE FROM YOUR SINGLE SOURCE

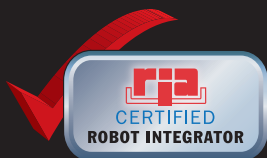

VERSA RC3L

Standard Dimensional Specifications

- Tool length **TL**
60-inches (1524-mm) to 96-inches (2438-mm)
- Tool swing diameter **SD**
40-inches (1016-mm) to 48-inches (1219-mm)
- Load height **LH**
36-inches (914-mm)
- Cell width **CW**
250-inches (6350-mm) to 275-inches (6985-mm)
- Cell depth **CD**
245-inches (6223-mm) to 271-inches (6883-mm)
- Cell height **CH**
93-inches (2362-mm)

Standard Capacity Specifications

- Weight capacity
1,000-lbs (453-kg)
- Engineering specifications for 1,000-lbs capacity per station
- Gearbox rated torque 4705Nm
 - Gearbox ratio 253:1
 - Gearbox maximum moment 20,580Nm
 - Motor maximum RPM 4,000
 - Motor torque output 18Nm
 - Nominal acceleration .5 seconds
 - 180-degree index time 5.0 seconds

Standard Platform Options

- Tool length 72-inches, 84-inches, 96-inches
- Tool Swing diameter 48-inch
- Exposed power track cable carrier system
- Smoke hood and extraction system
- Off-line programming
- LaunchIT or standard installation
- Training programs (basic, advanced, maintenance, off-line, CRAW)
- Intelligence Center™

Standard Component Options

- Robot models: FANUC, Panasonic, Motoman
- Process gear: Miller, Lincoln, Fronius, Thermadyne, Hypertherm
- Welding torches: Tregaskiss, Binzel, TBi, Fronius
- Torch cleaners: Tregaskiss, Binzel, TBi
- Controls: PanelView 1000+ Compact

TOP VIEW

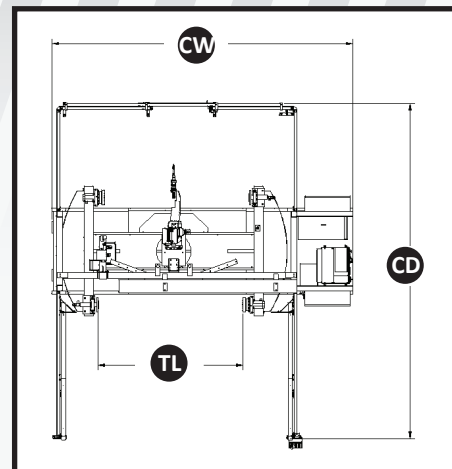

SIDE VIEW

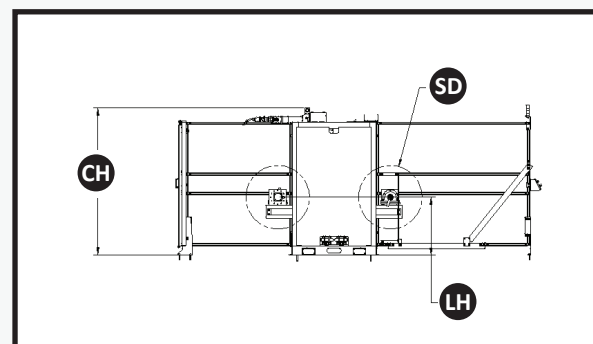

*Real time status, alarms, historical trends,
critical parameters and automatic backup of
your workcell anywhere, anytime.*